

## BURTONS SQUARE-END TUB TABLE

125-220-BUNDLE\*

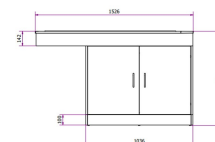
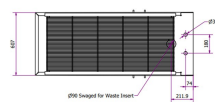

### PRODUCT DESCRIPTION

**Designed with a stainless steel tub top and laminate base, this unit makes dirty ops, dental work and other dirty procedures easier, cleaner and more efficient**

Featuring a 5.25" (13.34cm) deep heavy gauge 304-grade stainless steel tub with a long length removable grill and double door storage cupboard, the square end tub table is a cost effective addition to your practice.

#### Manufactured to last

We don't just supply it! It was designed and built by Burtons in the UK at our principle manufacturing facility in Maidstone, Kent Using the latest CNC's and laser manufacturing processes and high quality materials this product has been engineered from the ground up & built to last!

#### Features Include:

- Dimensions: 152cm L x 61cm W x90 cm H
- Complete with double door storage cupboard
- Left and right handed (You decide on install)
- Stainless steel tub

- Stainless steel grill
- Knee space design
- Taps and waste supplied separately

## ADDITIONAL INFORMATION

<b>Animal</b>	Small Animal
<b>SKU</b>	125-220-bundle*
<b>Colour/Style</b>	White
<b>Brand</b>	Burtons

### Good to know...

At Burtons we know you have a choice to shop with us, that is why we always aim to delight our customers with a fast, easy, shopping experience. Making and sourcing only the best products we can find to fit your needs. Price Matching: We regularly check all our prices against competitors so you don't have to. If you do find a like for like product cheaper we will aim to not just match it, but beat it! Backorders: All back ordered items will be ordered and shipped as quickly as we can to you. Special order items may take up to 4 weeks. Once ordered a member of our team will be in contact to keep you informed of estimated delivery dates. Returns Policy: You may return new, unworn or unused products within fourteen (14) days of delivery for a full refund of the cost of the goods, or an exchange if preferred. This is on top of your statutory rights